



buist rivers residence hall (coed/honors)



Buist Rivers Residence Hall is a four-story building arranged community style in which approximately 100 men (on the second floor) and women (on the third and fourth floors) live in two-person rooms.

Thirty-three residents share two community bathrooms in which there are four or five pedestal sinks, four private toilet stalls, three private showers with curtains, and one tub – with a white vinyl shower curtain – in each bathroom area. There is a private dressing area adjacent to each tub and shower, and there are towel bars, toiletry shelves, hooks and shower rods. There are no drawer or cabinet spaces for toiletry items.

The color scheme for all rooms is: white ceilings, ivory walls, and navy blue, aqua or coral trim (varies by floor). Bedroom floors are covered with ivory vinyl tile. Students may bring their own area rugs (a 3'x5' or 5'x8' rug easily fits).



There is a laundry room on the first floor and the Hawkins Lounge is available for studying and group events. In addition, there are common rooms on each floor – study rooms with one study table, four chairs, and four upholstered lounge chairs, and a computer lab. The building contains a multi-zone fire alarm system, digital security camera system and 24-hour information/security desk.



Elena Dowin '09
Raleigh, N.C.
Major: business administration
Minors: psychology, Jewish studies

"I love honors housing. It helps you develop a feeling of community right from the beginning. I lived in Buist my freshman year. We had study sessions in the hall – complete with pillows and p.j.s. In Rutledge, where I lived sophomore year, you get to pick a suite. It's a more private setting and gives you a quiet place to study."



buist rivers bedrooms

- Two wood-frame cherry-finish single beds (80" long x 36" wide) loftable* and bunkable – twin-long sheets
* gives approximately 66" of vertical clearance under the bed at full loft position and 30" of vertical clearance at semi-loft position.
- Two cherry-finish desks (42" wide x 24" deep x 30" high) with retractable keyboard and mouse surface with rear storage, retractable reference shelf, two open shelves and one storage drawer
- Two cherry wood-frame desk chairs with a navy blue upholstered seat
- Two cherry-finish chests of drawers (30" wide x 24" deep x 30" high). They are designed to align perfectly with the desks to create a 78" continuous work surface under the lofted bed assembly.
- Two large closets (53" wide x 32" deep x 96" high) with non-locking bi-fold doors
- One window: 44" wide x 72" high covered by 2" plantation blinds (students may drape fabric from the valance but may not use wall- or frame-fastened curtain rods)
- One cherry-finish TV cube with space on top for a TV, a fixed middle shelf that will hold a VCR or DVD player, and space below for a small stereo, CDs, tapes, etc. A three-pronged extension cord with surge protector and a coax cable (to connect a TV with the cable TV outlet) are required.
- One small microwave and compact refrigerator (3.6 cu. ft. interior capacity)
- Air conditioning
- Telephone hook-up (per bedroom)
- Basic cable television service (per bedroom)
- "Wired" Internet service (per student)

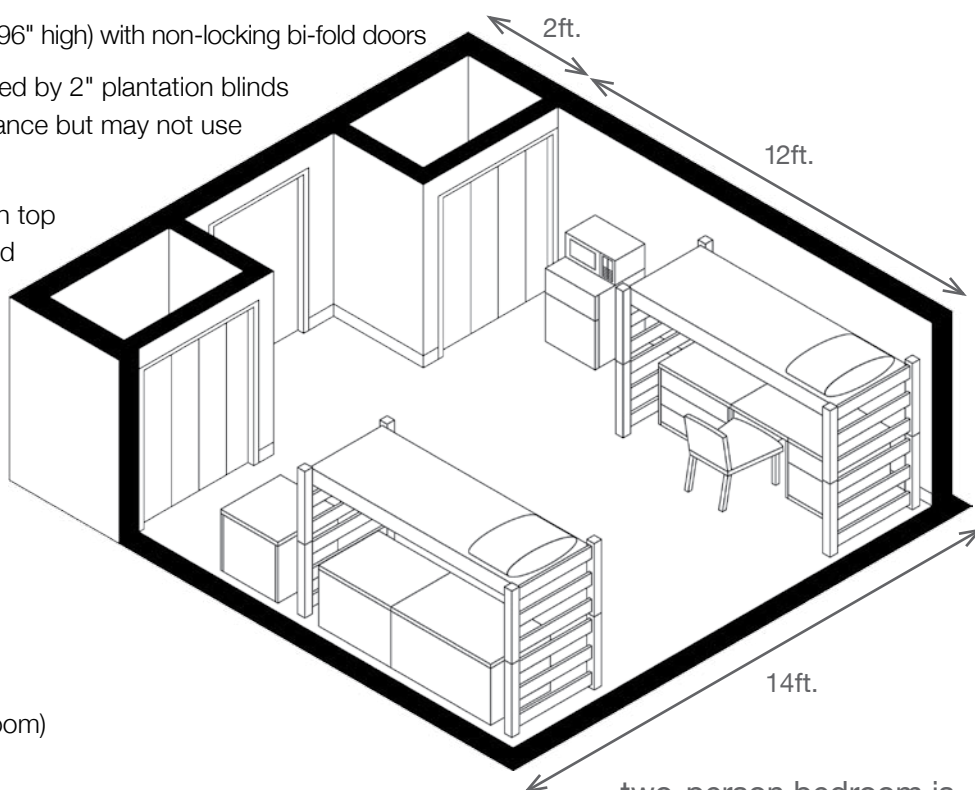

Although dimensions may vary slightly, bedrooms are typically 14'0" wide x 12'6" long.

two-person bedroom is 14ft. long by 12ft. wide

