



kelly house (coed/upperclassmen)



Kelly House is a four-story building where approximately 236 upperclassmen live. Floor plans vary. In the townhouse apartment, five residents share an apartment that consists of four bedrooms, two bathrooms and a living room with full kitchen. In Kelly House, there are two to five other floor plans that have residents sharing a single-level apartment with two to three bedrooms and one or two bathrooms.

The color scheme for all apartments is: beige walls and white ceilings, ivory doors, ivory trim. Each apartment has a kitchen with cabinets, sink with garbage disposal, dishwasher, stove, microwave, and full-size refrigerator (students may not bring microwaves and/or mini-refrigerators), a fully furnished living room with a built-in entertainment nook underneath the staircase, and a common area with three barstools at the kitchen counter, two loveseats, one TV cube (in single-level apartments) and one coffee table. The furniture has a cherry-wood finish. All bedrooms are carpeted and common rooms come with navy blue and beige checkerboard floor tile.



Suites have either one or two bathrooms, and two or three people share a bathroom. Each bathroom comes with a vanity area with sink, a toilet, and tub/shower combination (60" wide with a white vinyl curtain). The vanity has limited drawer and cabinet space. For additional storage, residents may bring over-the-toilet cabinets that are supported by poles; wall attachments are not allowed.



There is a laundry room on the premises. The building has a spacious landscaped courtyard, a digital security camera system, and 24-hour information/security desk.

Note: Kelly House does not have an elevator.



Steven Marano '05
Greenville, S.C.
Major: exercise science

"Kelly House was a wonderful experience. The layout of the two-person suite is great. I really enjoyed having a single room. It allowed me to have the company of my suite mate, but I still had the privacy of my own room. The suite is a perfect size and easy to keep clean. The maintenance staff does a great job with the upkeep of the building. And the laundry facilities are so convenient.

"The courtyard is a great place to play Frisbee, throw a football, or during the warmer months, work on your tan. The location of Kelly House is prime for walking to campus, and King Street is close by as well."



kelly house bedrooms (coed/upperclassmen)

- One or two wood-frame, cherry-finish single beds (80" long x 36" wide) – loftable* and bunkable – twin-long sheets
* gives approximately 66" of vertical clearance at full loft position and 30" of vertical clearance at semi-loft position
- One or two individual cherry-finish desks (42" wide x 24" deep x 30" high) with retractable keyboard and mouse surface with rear storage, retractable reference shelf, two open shelves and one storage drawer
- One or two desk chairs with navy blue upholstered seat and back with cherry-finish
- One or two three-drawer cherry-finish chest of drawers (30" wide x 24" deep x 30" high). Chest is designed to align with the desk to create an 8"-wide continuous surface.
- One or two closets with non-locking bi-fold door
- Window (average 33" wide x 70" high) with 1" aluminum mini-blinds (students may drape fabric from the valance but may not use wall- or frame-fastened curtain rods)
- Air conditioning
- Telephone hook-up (per bedroom-)
- Basic cable television service (per bedroom)
- "Wireless" Internet service (per student)

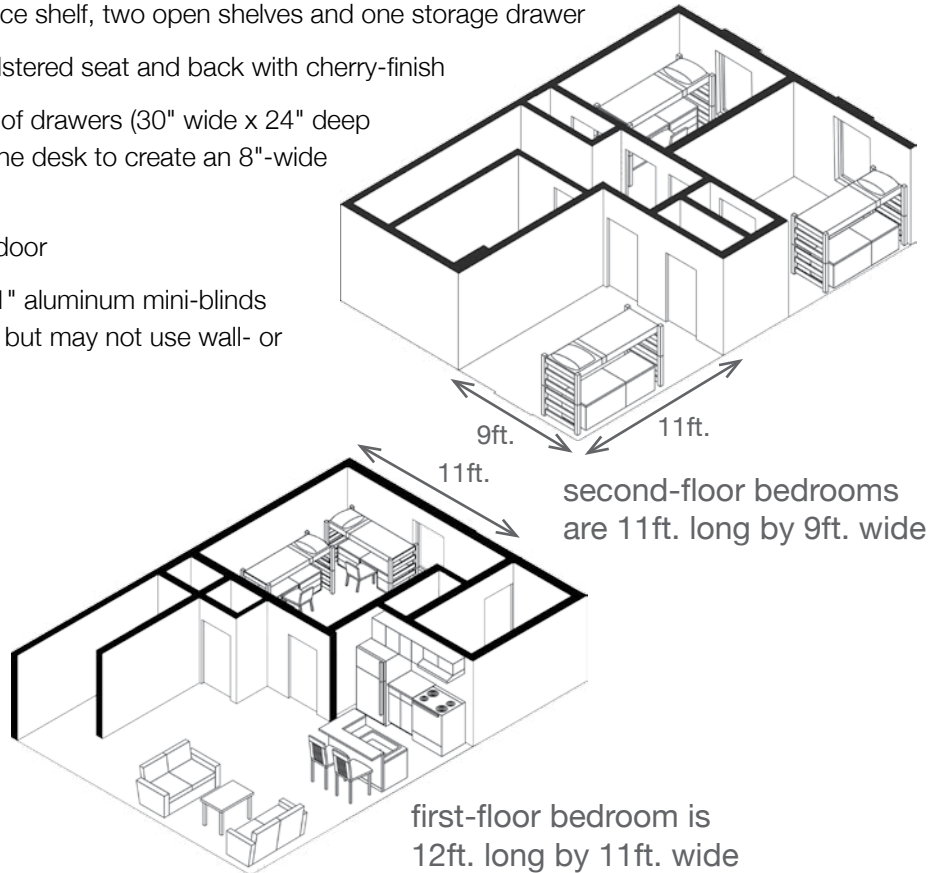

first floor and second floor
of townhouse apartment

