



rutledge rivers residence hall (coed/honors)



Rutledge Rivers Residence Hall is a four-story building in which approximately 100 upperclass Honors College men and women live in apartment-style suites (shared by two, four, or five students) that open to inside corridors. Each suite consists of one to three bedrooms, one or two bathrooms, a furnished living area and one full kitchen.

The common area in each suite is furnished with a cherry wood-finish dining table and chairs, one lounge chair, one sofa, one end table and one TV cube. Upholstery is multicolored. The kitchen comes with cabinets, open shelving, a sink, microwave and compact refrigerator (shared by one to five people). Only one supplemental refrigerator per bedroom is allowed (not to exceed 4.0 cu. ft. interior capacity and with a three-prong/120 volt plug). No additional microwaves are permitted.

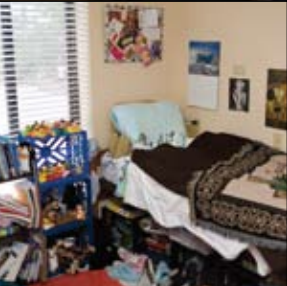

Suites have one or two bathrooms shared by two to three students and come with a pedestal sink, toilet, a tub/shower combination (60" wide with white vinyl curtain) and a towel bar. There is no drawer or cabinet space in the bathrooms. For additional storage, residents may bring over-the-toilet cabinets that are supported by poles; wall attachments are not allowed.

Color scheme for the common areas is: ivory walls, white ceilings, navy blue, aqua or coral trim (depending on the floor) door trim and full-spectrum daylight quality lighting. Floor coverings are: white tile with navy-, green-, yellow- and coral-striped accents in the common areas, and white tile in the bedrooms. Students may bring their own area rugs (a 3'x5' or 5'x8' rug easily fits).



Residents of Rutledge Rivers share Hawkins Lounge (for studying and group events) and a computer lab with the residents of Buist Rivers. There is a laundry room on the first floor of Rutledge Rivers. In addition, the building contains a multi-zone fire alarm system, digital security camera system and 24-hour information/security desk.

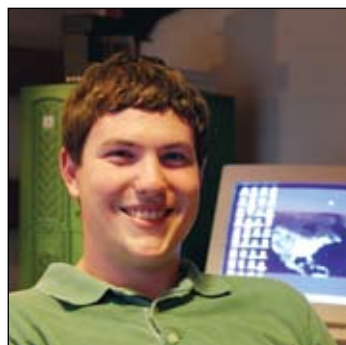

Josh Gray '07
Columbia, S.C.
Major: athletic training

"Rutledge is great. The style and layout of the suite are probably Rutledge's best assets. The common area provides a very social atmosphere – an area where friends can watch movies or play cards or just hang out. I also enjoyed having a kitchen so I could cook."



rutledge rivers bedrooms

- Two wood-frame cherry-finish single beds (80" long x 36" wide), lofted* and bunkable – twin-long sheets
* gives approximately 66" of vertical clearance under the bed at full loft position and 30" of vertical clearance at semi-loft position
- Two cherry-finish desks (42" wide x 24" deep x 30" high). Each desk has a retractable keyboard and mouse surface with rear storage, retractable reference shelf, two open shelves and one storage drawer.
- Two cherry wood-frame desk chairs with a navy blue upholstered seat and back
- Built-in floor-to-ceiling storage assembly consisting of closets, drawers and storage cabinets
- Two cherry-finish three-drawer chests (30" wide x 24" deep x 30" high) that are designed to align perfectly with the desks to create a 72" wide continuous work surface that fits under the lofted bed assembly.
- One window: 44" wide x 81" high (93" in first-floor rooms) covered by 2" plantation blinds (students may drape fabric from the valance but may not use wall- or frame-fastened curtain rods)
- Air conditioning
- Telephone hook-up (per bedroom)
- Basic cable television (per bedroom)
- "Wired" Internet service (per student)

Double-occupancy bedrooms in the one-bedroom apartments measure 10'6" wide x 11'9" long. Double-occupancy bedrooms in three-bedroom apartments measure 10'0" wide x 11'6" long. Single-occupancy bedrooms in the three-bedroom apartments measure 7'4" wide x 11'4" long. Dimensions may vary slightly.

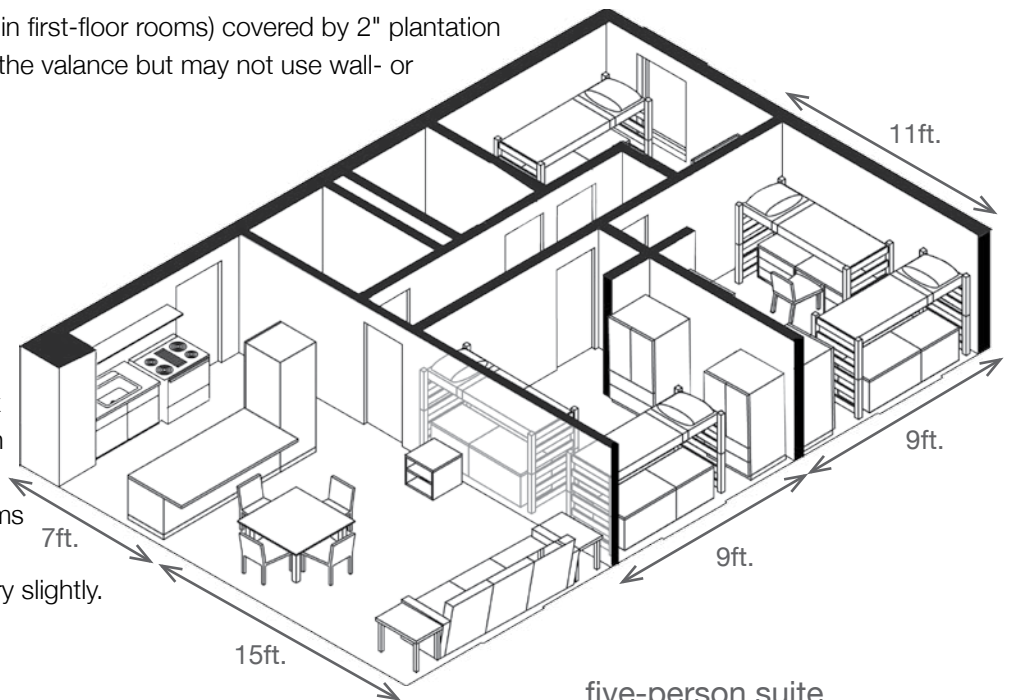

five-person suite
bedroom is
9ft. long by 11ft. wide

